

| PLANT LIST                               |     |  |                                  |           |        |            |
|--|-----|--|----------------------------------|-----------|--------|------------|
| KEY                                      | QTY | BOTANICAL NAME                                 | COMMON NAME                      | SIZE      | TYPE   | REMARKS    |
| <b>TREES</b>                             |     |  |                                  |           |        |            |
| AR                                       | 3   | ACER RUBRUM 'KARPICK'                          | KARPICK MAPLE                    | 70 MM CAL | WB     | COLUMNAR   |
| AS                                       | 3   | ACER SACCHARUM 'ENDOWMENT'                     | ENDOWMENT MAPLE                  | 70 MM CAL | WB     | COLUMNAR   |
| GB                                       | 4   | GINKGO BILOBA 'PRINCETON SENTRY'               | PRINCETON SENTRY MAIDENHAIR TREE | 70 MM CAL | WB     | COLUMNAR   |
| PP                                       | 14  | PICEA PUNGENS 'FAT ALBERT'                     | FAT ALBERT SPRUCE                | 250 CM HT | WB     |            |
| QM                                       | 2   | QUERCUS MACROCARPA                             | BUR OAK                          | 70 MM CAL | WB     |            |
| TA                                       | 5   | TILIA AMERICANA 'REDMOND'                      | REDMOND BASSWOOD                 | 70 MM CAL | WB     |            |
| UA                                       | 8   | ULMUS AMERICANA 'VALLEY FORGE'                 | VALLEY FORGE AMERICAN ELM        | 70 MM CAL | WB     |            |
|  | 39  | <b>TOTAL TREES</b>                             |                                  |           |        |            |
| <b>SHRUBS</b>                            |     |  |                                  |           |        |            |
| DL                                       | 36  | DIERVILLA LONICERA                             | BUSH HONEYSUCKLE                 | 60CM HT   | POTTED | 1.0M O.C.  |
| RT                                       | 7   | RHUS TYPHINA 'BAILTIGER'                       | TIGER EYES CUTLEAF SUMAC         | 60CM HT   | POTTED |            |
| JS                                       | 62  | JUNIPERUS SABINA 'BUFFALO'                     | BUFFALO JUNIPER                  | 60CM SPR  | POTTED | 1.2M O.C.  |
| PO                                       | 43  | PHYSOCARPUS OPULIFOLIUS 'DIABLO'               | DIABLO NINEBARK                  | 60CM HT   | POTTED | 1.2M O.C.  |
| VD                                       | 35  | VIBURNUM DENTATUM 'CHRISTOM'                   | BLUE MUFFIN VIBURNUM             | 60CM HT   | POTTED | 1.5M O.C.  |
|  | 183 | <b>TOTAL SHRUBS</b>                            |                                  |           |        |            |
| <b>PERENNIALS AND ORNAMENTAL GRASSES</b> |     |  |                                  |           |        |            |
| PAN                                      | 5   | PANICUM VIRGATUM 'HEAVY METAL'                 | BLUE SWITCHGRASS                 | -         | 1 GAL  | 0.75M O.C. |
| SOR                                      | 18  | SORGHASTRUM NUTANS                             | INDIAN GRASS                     | -         | 1 GAL  | 1.0M O.C.  |
|  | 23  | <b>TOTAL PERENNIALS AND ORNAMENTAL GRASSES</b> |                                  |           |        |            |

**GENERAL NOTES**

- Drawings L1 and L2 have been coordinated with the project Civil drawings prepared by Meritech Engineering and Site Plan drawings prepared by Levitt Goodman Architects.
- All dimensions are in metric, unless otherwise noted.
- Do not scale drawings. Dimensions are to be verified on site by Contractor.
- This plan is to be read in conjunction with all details, notes and written specification.
- This drawing shall not be used for construction purposes unless noted below as "Issued for Construction".
- Depicted on this plan are the species and the approximate location of street trees. Once driveways, utilities and light standards have been installed, the exact location of street trees will be determined by the Landscape Architect and approved by the City prior to planting.
- Contractor shall review all drawings and verify field conditions, report any discrepancies to the Landscape Architect prior to construction.
- Landscape Architect shall approve all layout and staking prior to commencement of work.
- Limit of work, access routes and storage areas are to be defined in the field by Owner prior to construction.
- Any areas outside the limit of work damaged by the Contractor shall be restored by the Contractor to the satisfaction of City of Waterloo at no additional cost to the Owner.
- Where new paving or earthworks meets existing paving or earthwork, smoothly blend line and grade of existing with new.
- Contractor shall locate all underground and overhead utilities prior to commencement of any work. All utilities not necessarily shown on this plan, Aboud & Associates assumes no responsibility for the accuracy of any utilities on this plan.
- Substitution of materials must be approved by the Landscape Architect in writing.
- Material quantities on drawings shall take precedent over those in lists.
- Plant material to be No. 1 grade, nursery grown in accordance with the Canadian Nursery Landscape Association.
- Landscape Architect reserves the right to reject any plant material displaying life-threatening poor growth habits, injury, disease or those not true to name, form or size. Contractor shall remove rejected material from site immediately and replace at no additional cost to Owner.
- Plants which come over or under any utility shall be relocated by Landscape Architect in consultation with Project Engineer.
- Mulch trees and shrubs in continuous beds.
- All work and materials are to be guaranteed by the Contractor for two (2) years from date of final acceptance by Landscape Architect.
- Any Plant material substitutions must be to the satisfaction of the City of Waterloo.

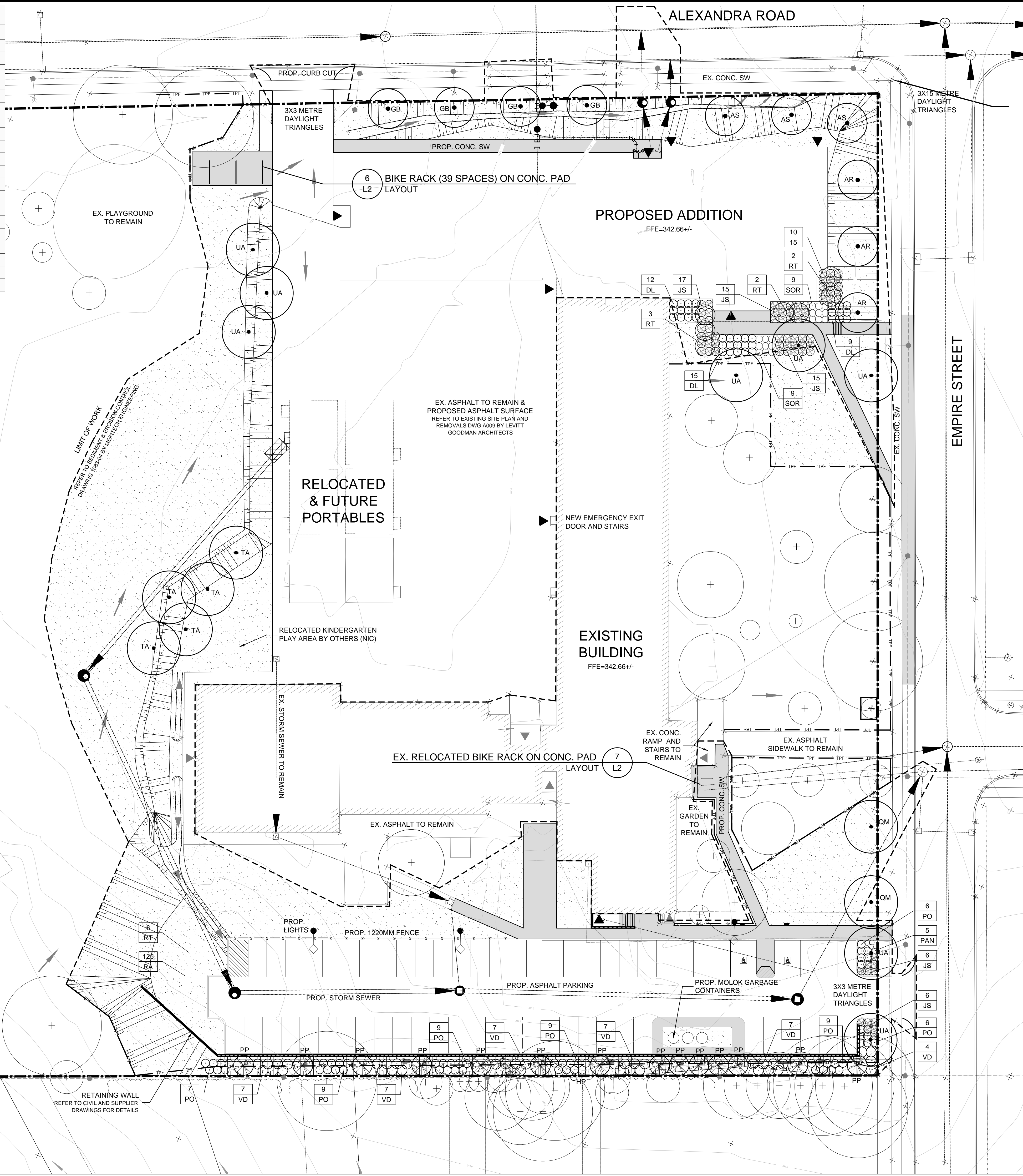

**LEGEND:**

- PROPOSED DECIDUOUS TREES
- PROPOSED CONIFEROUS TREES
- PROPOSED DECIDUOUS SHRUBS
- PROPOSED CONIFEROUS SHRUBS
- PROPOSED ORNAMENTAL GRASSES
- PROPOSED TOPSOIL AND SOD
- QTY UA PLANT KEY
- EXISTING TREE TO REMAIN REFER TO VEGETATION MANAGEMENT DRAWING T1 BY ABOUD & ASSOCIATES
- PROPERTY BOUNDARY
- LIMIT OF WORK REFER TO SEDIMENT & EROSION CONTROL DRAWING 1083-04 BY MERITECH ENGINEERING

RESTORE EXISTING TURF DISTURBED BY CONSTRUCTION WITH TOPSOIL AND SOD

**INFORMATION SOURCES**

- Base Plan prepared by Meritech Engineering dated November 9, 2012.
- Tree data collected by Aboud & Associates on August 1, 2012.

| No. | Description       | By | Date      |
|-----|-------------------|----|-----------|
| 2   | REVISED SITE PLAN | MN | 8 NOV-12  |
| 1   | CITY COMMENTS     | MN | 16 OCT-12 |
| 0   | FIRST SUBMISSION  | MN | AUG-12    |

REVISIONS: All previous issues of this drawing are superceded

**ABOUT & ASSOCIATES INC.**  
 Consulting Arborists • Ecologists • Landscape Designers  
 591 Woodloch Street, Guelph, Ontario, Canada, N1H 3Y5  
 T: 519.822.6839, F: 519.822.4052, info@aboudguthm.com, www.aboudguthm.com

**LANDSCAPE PLAN**

Project: **EMPIRE PUBLIC SCHOOL**  
 83 EMPIRE ST. WATERLOO  
 WATERLOO REGION DISTRICT BOARD OF EDUCATION

Date: AUG 2012 Designer: SK  
 Project: AA12-00A Drawn: SK  
 Scale: 1:300 Checked: MGN

Association of Landscape Architects of Ontario (ALA) logo and other professional seals.